

# Savage River Bank Stabilization CLOMR/LOMR

Garret County, Maryland

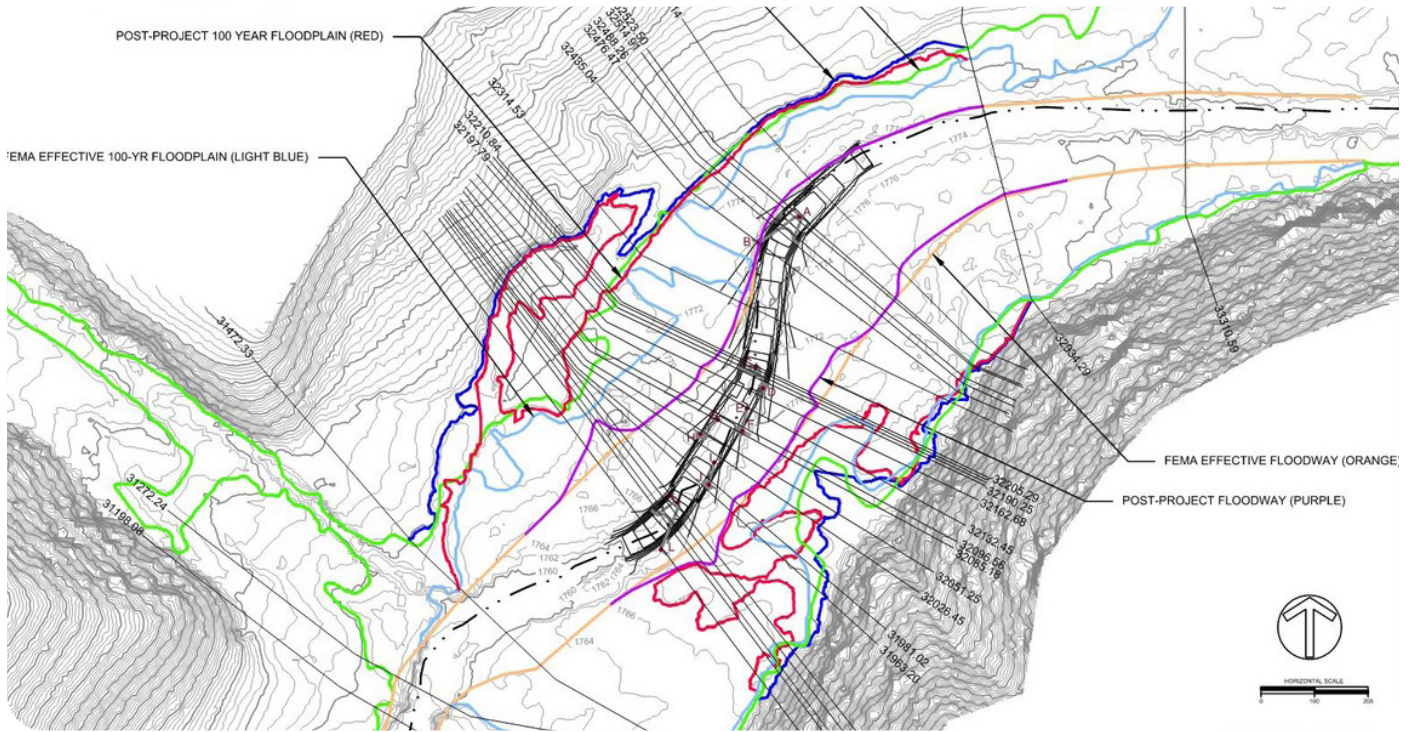

*FEMA studies for a stream restoration project efforts to improve water quality, landscape resilience, biodiversity, and quality of life in Central Appalachia.*

## SERVICES

Floodplain Modeling

The Canaan Valley institute (CVI) is a nonprofit organization dedicated to improving water quality, landscape resilience, biodiversity, and quality of life across Central Appalachia. After designing and implementing a bank stabilization project along the Savage River in western Maryland, CVI turned to Biohabitats for help in preparing a package to request Conditional Letter of Map Revision (CLOMR) and Letter of Map Revision (LOMR) from the Federal Emergency Management Agency (FEMA).

Biohabitats began by reviewing the as-built plan information and comparing it with the original project plans submitted to FEMA prior to construction. The comparison indicated that re-modeling and re-delineation of the as-built conditions would be required in order to request a Letter of Map Revision. Biohabitats then updated the final condition HEC-RAS model, as well as the floodplain and floodway delineations based on the as-built information.

Biohabitats prepared the LOMR application package, which included data, forms, and a certified topographic work map, in a manner that satisfied all DHS-FEMA NFIP regulatory requirements. Biohabitats also provided one model revision and responded to FEMA comments on the submittal. The submittal was ultimately approved by FEMA.